

# ICE SHOT DISPENSER

Model # CSD-250

---

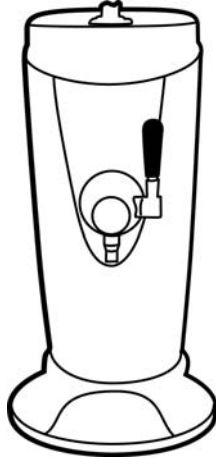

---

**For Household Use Only**  
**Read These Instructions Before Using This Unit!**  
***Save These Instructions!***

## IMPORTANT PRECAUTIONS

---

- A. NEVER place on (or near) a hot gas or electric burner or in a heated oven.
- B. Keep out of the reach of children.
- C. DO NOT place in dishwasher.
- D. This ICE SHOT DISPENSER™ is NOT A TOY!

## ABOUT YOUR ICE SHOT DISPENSER™

---

This unit is an insulated liquor shot dispenser that uses ice for refrigeration. Unlike simply pouring over ice, the ICE SHOT DISPENSER™ breaks the traditional limitation of “watering down” the original taste. The cooling system operates as a result of circular, aluminum pipes inside the dispenser. When alcohol flows through the pipes, it immediately becomes cold due to the ice surrounding.

### BREAKDOWN...

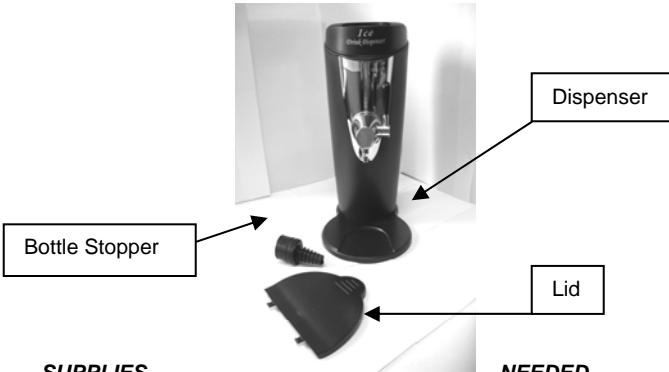

### SUPPLIES

- Rock Salt
- 1/2 Cup Boiling Hot Water
- 1/2 Cup Ice Cold Water
- Crushed Ice
- Favorite Liquor

### NEEDED...

### SET UP AND OPERATION...

1. First, prepare a mixture of 2 Tablespoons of Rock Salt in 1/2 cup of boiling hot water. Allow the salt to dissolve. Add the 1/2 cup of ice cold water to cool down.
2. Open the lid from the top of the dispenser, and put ice into the bucket. Pour the salt water mixture over the ice to expedite its frost effect, and close the lid.

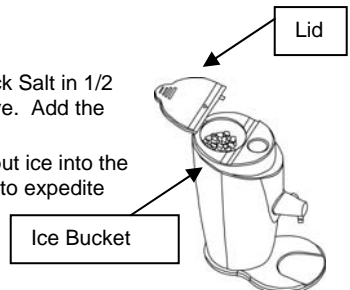

## ABOUT YOUR ICE SHOT DISPENSER™ (Continued)

3. Open your liquor bottle. Insert the Bottle Stopper into the bottleneck tightly.

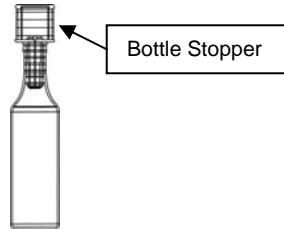

4. Turn the bottle upside down and insert the bottle with the bottle stopper into the flow position (above the dispenser) tightly.

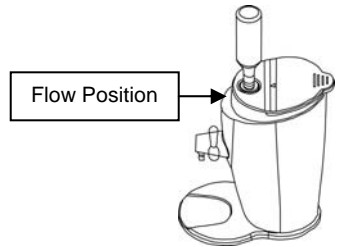

5. Place a shot glass under the spout. Push the handle forward. After about 60 seconds, your cold alcohol shot will pour out while retaining all the intensity of the flavor.

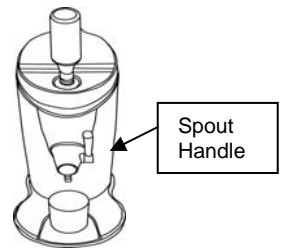

6. As the ice melts, water will collect in a reservoir inside the dispenser unit. Place a cup under the drain nozzle located at the back side of the dispenser, and remove the nozzle plug. Allow to drain completely. Replace the nozzle plug when reservoir is emptied.

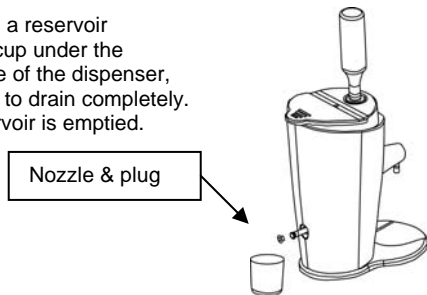

## CLEANING

---

The ICE SHOT DISPENSER™ is easy to clean. Simply run hot water through the bottle stopper by filling an empty bottle with hot water and allowing it to flow out through the spout. You can also fill the ice bucket with hot water and allow it to flow through the aluminum coils. Dispose of the water through the dispenser rear nozzle and plug.

To maintain the exterior finish of the ICE SHOT DISPENSER™, wipe down using a non abrasive sponge or cloth with warm sudsy water and dry with a non abrasive clean cloth.

## RETURNS & WARRANTY

---

Should your unit not work properly or should you have any questions, please contact us at the numbers below between the hours of 8:00 am to 5:00 pm, Monday through Friday Pacific Standard Time.

Distributed by:

The Helman Group, Ltd.  
1621 Beacon Place  
Oxnard, Ca 93033  
805-487-7772  
Fax: 805-487-9975  
info@helimangroup.com  
www.helimangroup.com

ICE SHOT DISPENSER™  
Model # CSD-250  
Limited Warranty

This appliance is designed and built to provide many years of satisfactory performance under normal household use. The distributor pledges to the original owner that should there be any defects in material or workmanship during the first 90 days of purchase, we will repair or replace the unit at our option. Our pledge does not apply to damages caused by shipping, mishandling or unit being dropped. A product deemed defective either from manufacturing or being mishandled is up to the distributor's discretion. To obtain service under this warranty, return this unit to The Helman Group, Ltd. at the address above, shipping prepaid. You must also include a copy of the original receipt along with your name, address and phone number. Include a description of the defect along with the date you purchased the product.

Please read these instructions carefully. Failure to comply with these instructions, damages caused by improper replacement parts, abuse or misuse will void this pledge to you and is being made in place of all other expressed warranties.



The Helman Group, Ltd  
1621 Beacon Place  
Oxnard, CA 93033

(805) 487-7772 phone  
(805) 487.9975 fax

Visit Us Online at  
**[www.helmangroup.com](http://www.helmangroup.com)**

©2007 The Helman Group, Ltd.